

***NEVER JUST STAY. STAY INSPIRED.***

CONRAD®  
HAMBURG

## GENERAL INFORMATION

The Conrad Hamburg, opening in summer 2025, marks the German debut of the Conrad by Hilton brand and offers timeless luxury in the heart of the Hanseatic city.

## GUESTROOMS + SUITES

The hotel features 283 rooms, including 28 studios with kitchenettes and 29 suites. The generously sized guest rooms, starting at 32 m<sup>2</sup>, combine stylish design with the highest level of comfort and are well equipped, including openable windows. A special highlight is Hamburg's largest Presidential Suite, offering an impressive 279 m<sup>2</sup> of luxurious space.

## HEALTH + FITNESS

The 1,000 m<sup>2</sup> Levante Spa includes a huge gym, a 20-meter pool, saunas, as well as an extensive range of treatments and wellness services.

## LOCATION

Thanks to its prime location on Mönckebergstraße, key destinations such as the Alster, Jungfernstieg, and Neuer Wall are just a short walk away. Nearby landmarks such as the City Hall, the Alster, and Hafencity with the Elbphilharmonie are also within easy walking distance.

## CAPACITY CHART

MEETINGROOM	m <sup>2</sup>	DAY LIGHT	THEATER	PARLAMENT	CABARET	BANQUET	U-FORM	BOARD
Board Room 1	31	Yes	-	-	-	-	-	10
Board Room 2	35	Yes	-	-	-	-	-	12
3 Drei	72	Yes	77	40	24	40	20	16
4 Vier	33	Yes	36	16	12	20	10	12
3 + 4 Drei und Vier	105	Yes	116	60	36	60	30	28
Executive Lounge 2	65	Yes	-	-	-	-	-	-
5 Fünf	53	Yes	52	20	18	30	16	12
6 Sechs	63	Yes	65	28	26	40	22	16
7 Sieben	74	Yes	80	24	26	40	20	16
8 Acht	63	Yes	65	28	26	40	22	16
6 - 8 Sechs bis Acht	200	Yes	210	100	84	140	-	-
Levante 7th Floor	113	Yes	-	-	-	-	-	14



## RESTAURANT + BAR

At the GRETA OTO restaurant, guests can look forward to a unique culinary experience focused on Latin American cuisine.

The indoor space offers 118 seats, with an additional 35 seats available on the sun-drenched terrace. For more intimate gatherings, "La Mesa" offers an exclusive setting for up to 12 guests. The evening can be concluded with a visit to the GRETA OTO Bar with its Signature Drink Pisco Sour.

## RESTAURANT FLOOR PLAN

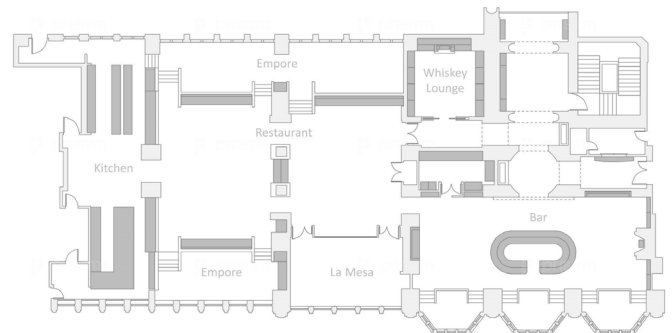

## MEETINGS + EVENTS

The luxury hotel is located in the historic **Levantehaus**, an impressive commercial building dating back to 1912, in a prime central location on **Mönckebergstraße**.

### CONFERENCES

Thanks to its central location and excellent connections to Hamburg Central Station and the airport, the new Conrad Hamburg offers the perfect setting for any type of event. Guests can choose from a selection of tailored meeting rooms, a thoughtful catering concept, and a highly motivated service team that ensures every event is a success.

- Nine distinctive event spaces are available for conferences, meetings, and events with up to 220 guests.
- All rooms feature natural daylight and large windows that can be opened.
- The event floor is located on the second level of the hotel, alongside the lobby and dining areas.

### FACILITIES

Flexible room concepts seamlessly adapt to individual requirements - ranging from modern boardrooms of 31 m<sup>2</sup> to spacious conference areas of up to 200 m<sup>2</sup>. All rooms are equipped with state-of-the-art AV equipment, providing the perfect setting for unforgettable events.



### CONFERENCE ROOM FLOOR PLAN

